

E-HEADER/SILL RECOMMENDED INSTALLATION INSTRUCTIONS

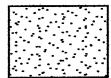
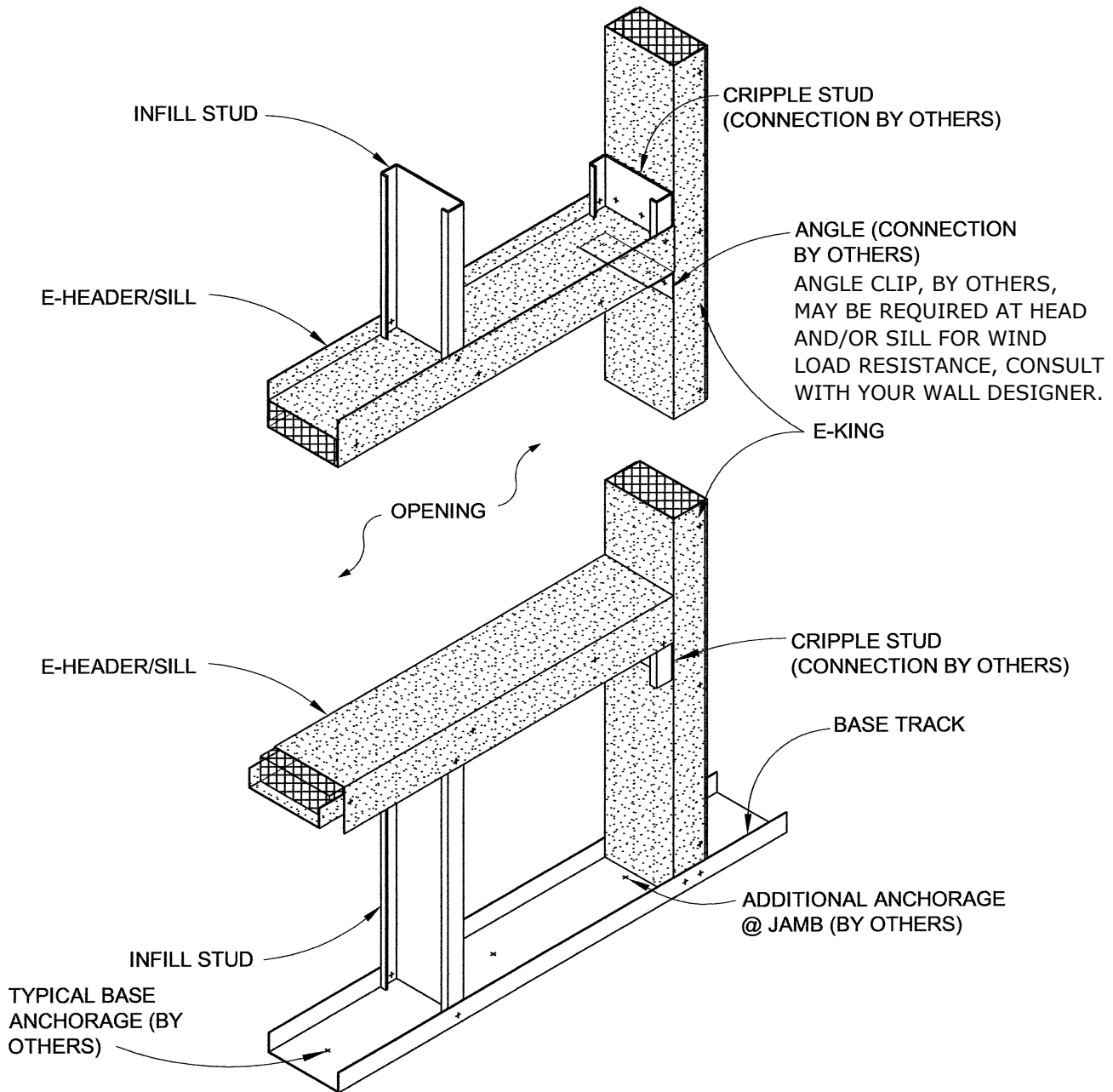

INDICATES ENVIRO-BEAM PRODUCTS

NOTE:

1. DETAIL IS BASED ON THE SUGGESTED DETAILS IN THE SSMA COLD FORMED STEEL DETAILS MANUAL.
2. SIZE AND GAGE OF THE E-HEADER/SILL, E-KING, AND CONNECTIONS SHALL BE DETERMINED BY THE DESIGNER BASED ON PROJECT REQUIREMENTS.
3. WHEN CUTTING E-HEADER/SILL TO SHORTER LENGTHS A FASTENER (SHEET METAL SCREW) MUST BE ADDED TO BOTH SIDES TO MAINTAIN A 3" MAXIMUM SPACING OF FASTENERS FROM CUT ENDS.
4. AN EXCELLENT CUTTING BLADE FOR STEEL IS THE 'COLD CUT 1000' SERIES CERMET TIPPED BLADES BY CUT TECHNOLOGIES METAL. ASK YOUR ENVIRO PRODUCTS DISTRIBUTOR FOR DETAILS.